

MAIN FIGURE			AREAS	
SIDES	ANGLES OF	CO-ORDINATES	ERF	SQUARE
METRES	DIRECTION	Y System: WGS 1984 X	NUMBER	METRES
AB	20.00	354 01 50	460	394
BC	31.00	264 01 50	461	474
CD	10.67	384 01 50	462	424
DE	19.20	357 50 00	463	342
EF	25.00	3 30 40	464	362
FG	28.15	273 30 40	465	250
GH	12.93	270 00 00	466	250
IJ	173.79	3 30 40	467	342
JK	115.74	93 30 40	468	340
KL	16.28	172 53 20	469	305
LM	25.00	183 30 40	470	470
MN	30.00	93 30 40	471	223
NP	107.00	183 30 40	472	225
OQ	5.00	93 30 30	473	225
QR	25.00	183 30 30	474	225
RS	36.00	273 30 30	475	225
ST	25.00	183 30 30	476	244
TU	14.87	273 30 30	477	430
UV	38.13	175 25 10	480	230
VA	30.35	261 07 40	481	481
TOWN SURVEY MARKS				
22CD10	+	47 333.94	+	43 312.76
23CD10	+	47 323.69	+	43 770.08
REFERENCE MARKS				
227B544	+	45 310.74	+	41 691.38
228B544	+	45 638.41	+	41 682.38
BLOCK CORNERS				
A1	+	45 423.38	+	41 265.88
A2	+	45 479.86	+	41 262.41
B1	+	45 387.29	+	41 483.46
B2	+	45 480.89	+	41 458.94
B3	+	45 466.51	+	41 452.59
B4	+	45 454.12	+	41 413.68
B5	+	45 458.82	+	41 408.98
B6	+	45 418.16	+	41 411.47
B7	+	45 418.28	+	41 413.47
B8	+	45 398.32	+	41 414.69
B9	+	45 397.82	+	41 406.62
B10	+	45 403.28	+	41 408.29
B11	+	45 406.09	+	41 403.11
B12	+	45 402.04	+	41 337.17
B13	+	45 399.93	+	41 335.29
B14	+	45 399.51	+	41 328.46
B15	+	45 406.40	+	41 328.03
B16	+	45 408.52	+	41 323.91
B17	+	45 453.80	+	41 327.13
B18	+	45 458.49	+	41 321.83
B19	+	45 456.04	+	41 281.91
B20	+	45 450.74	+	41 277.22
C1	+	45 509.44	+	41 335.80
C2	+	45 503.75	+	41 341.10
C3	+	45 507.30	+	41 368.99
C4	+	45 509.42	+	41 400.88
C5	+	45 509.85	+	41 407.85
C6	+	45 502.86	+	41 408.28
C7	+	45 500.75	+	41 406.40
C8	+	45 481.79	+	41 407.57
C9	+	45 477.10	+	41 412.86
C10	+	45 479.49	+	41 451.79
C11	+	45 485.84	+	41 457.41
C12	+	45 528.40	+	41 334.58
D1	+	45 473.70	+	41 275.62
D2	+	45 469.01	+	41 281.11
D3	+	45 471.46	+	41 321.04
D4	+	45 476.78	+	41 325.72
E1	+	45 454.54	+	41 339.11
E2	+	45 419.33	+	41 341.27
E3	+	45 414.64	+	41 346.56
E4	+	45 417.58	+	41 394.47
E5	+	45 422.58	+	41 396.16
E6	+	45 458.09	+	41 397.00
E7	+	45 462.77	+	41 391.70
E8	+	45 459.83	+	41 343.79
F1	+	45 488.47	+	41 337.03
F2	+	45 477.49	+	41 337.70
F3	+	45 472.81	+	41 343.00
F4	+	45 475.87	+	41 392.90
F5	+	45 481.17	+	41 397.59
F6	+	45 482.15	+	41 395.91
F7	+	45 496.83	+	41 391.62
F8	+	45 494.29	+	41 350.19
F9	+	45 491.30	+	41 350.38
F10	+	45 490.90	+	41 343.89
F11	+	45 493.89	+	41 343.71
F12	+	45 493.77	+	41 341.71

MAIN FIGURE BEACON DESCRIPTIONS  
ALL ARE 12mm IRON PEG

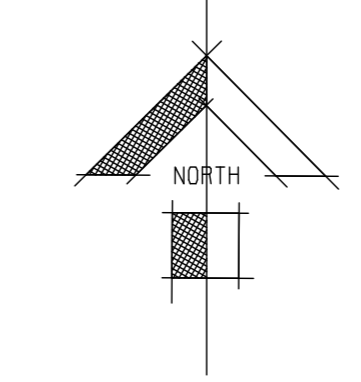
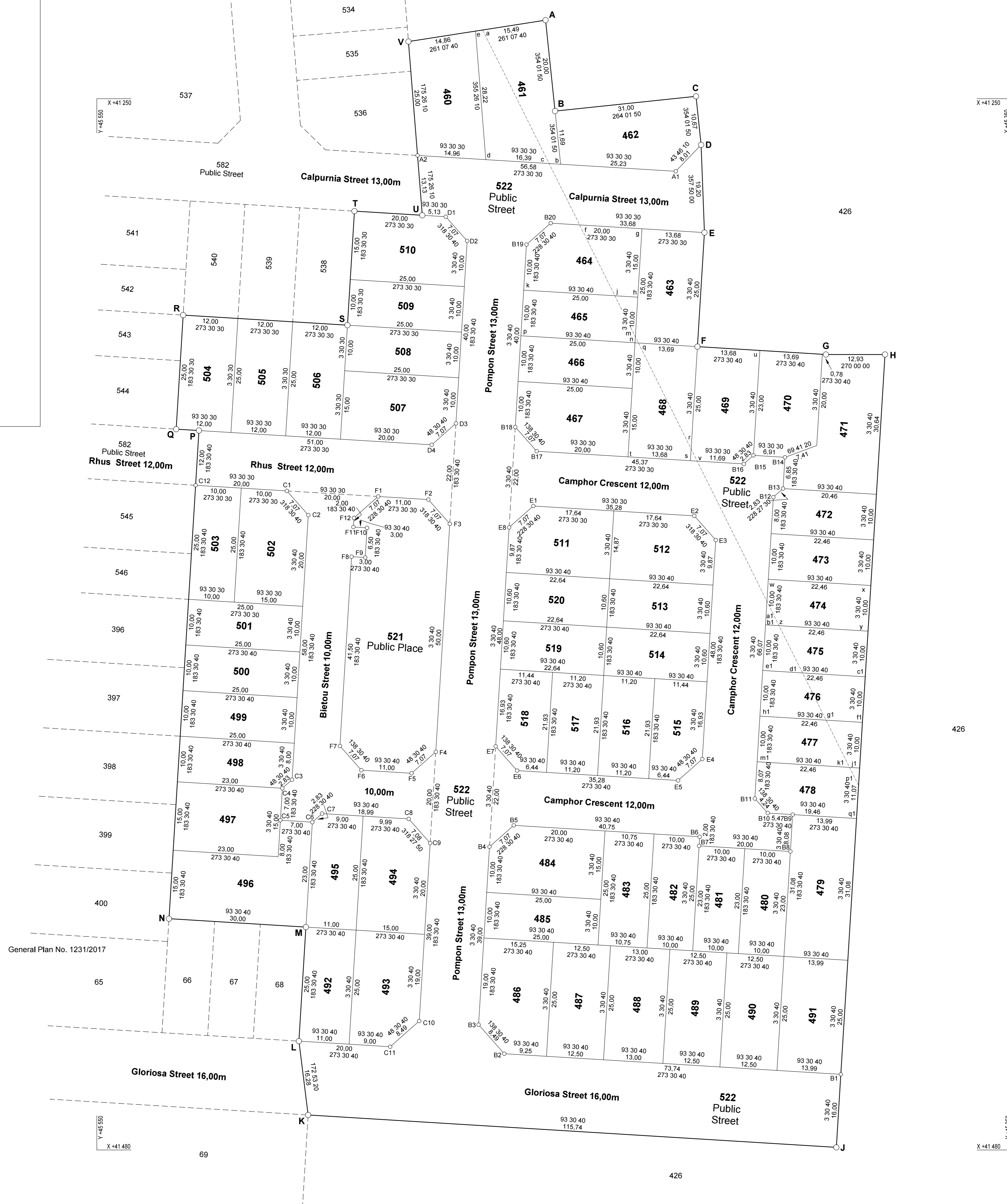

S.G. No. 2390/2018  
 APPROVED  
 Signed G. Abrey  
 for SURVEYOR - GENERAL  
 25.01.2019  
 APPROVED IN TERMS OF SECTION 98  
 OF MUNICIPAL BYLAW OF ACT 93/2014  
 REFERENCE Case ID 70371739  
 DATE 17-10-2018  
 EXEMPT FROM THE PROVISIONS OF ACT  
 70 OF 1970  
 SECTION 1(a)

CDR

GENERAL PLAN No. 2390/2018  
 OF  
 SUBDIVISIONS OF ERF 445 SANDOWN

WIDE DUMMY DGM. No. ANNEXED TO  
 COMPRISING 61 ERVEN NUMBERED 460 - 520  
 AND 1 PUBLIC PLACE NUMBERED 521  
 AND 1 PUBLIC STREET NUMBERED 522  
 SITUATE IN THE CITY OF CAPE TOWN  
 ADMINISTRATIVE DISTRICT OF CAPE  
 PROVINCE OF WESTERN CAPE

SCALE 1 : 400

SURVEYED IN OCTOBER 2000 - OCTOBER 2018  
 BY ME

*W. Abrahamse*  
 R. C. ABRAHAMSE  
 PROFESSIONAL LAND SURVEYOR  
 P.L.S. No. 0002

ENDORSEMENTS					
NO	AMENDMENT	ADDITION	AUTHORITY	INTD	DATE

S. G. OFFICE NOTES